

VBSS LOG BOOK^②

APRIL 27th 1946

TO

AUGUST 18th 1947

~~University of Bristol~~
UNIVERSITY OF BRISTOL

SPELEOLOGICAL SOCIETY

Printed by
JEFFERSON, SONS & CO.,
Printers & Stationers
BALDWIN STURLEY, BRISTOL
Telephone 4111
33, ST. STEPHENS STREET

Field Headquarters

LOG

April 1946 — August 1947

CAMP RULES

- i) This log book must be written up after each camp and all work done must be recorded.
- ii) No casings clothes may be stored in the hut nor may any person change into or out of casings clothes inside the hut. The clothes shed only, must be used for clothes storage.
- iii) After each camp, the fire must be properly extinguished, the grate cleaned, the wood bunkers filled & the hut ^{swept} ~~swept~~. All food must be stored in tins ONLY.
- iv) All waste material/s must be removed from the hut (by the proper receptacle) & placed in appropriate pit.
- v) Paraffin may not be used to light the fire, although candle ends may be used in times of emergency.

vi) Parties visiting caves will leave a note stating persons, destination & time of departure with date, in an obvious position in the hut.

vii) It is essential that the hut is properly bolted & shuttered, & the last person to leave will be held responsible in the event of theory through neglect of these precautions.

viii) After each camp, bunks must be adjusted so that each has its mattress &/or sleeping bag & fair number of blankets. Personal possessions may not be left on bunks between camps.

The Secretary
24/4/46

RULES

60

USE OF
TIMBER
On

5

Professor Treatment's land adjoining field headquarters hut

- i) This land may be used by the society provided they do not interfere with the tenants of Hill Cottage.
- ii) The society may cut for its own use
 - a) birch trees.
 - b) dead wood
 - c) ash saplingsprovided that 1 good tree or ash sapling is left at intervals of 4 or 5 feet.
- iii) Trees are to be cut as low to the ground as possible, & in falling it is necessary to arrange that no other trees are damaged by the falling timber.
- iv) Brushwood obtained from the felled trees should not be removed for use as fuel in suitably placed piles.

P.P. Professor E.F. Treatment. (Vice President)

P.P. Professor J.F. Dobson (President)



Hon. Secretary.

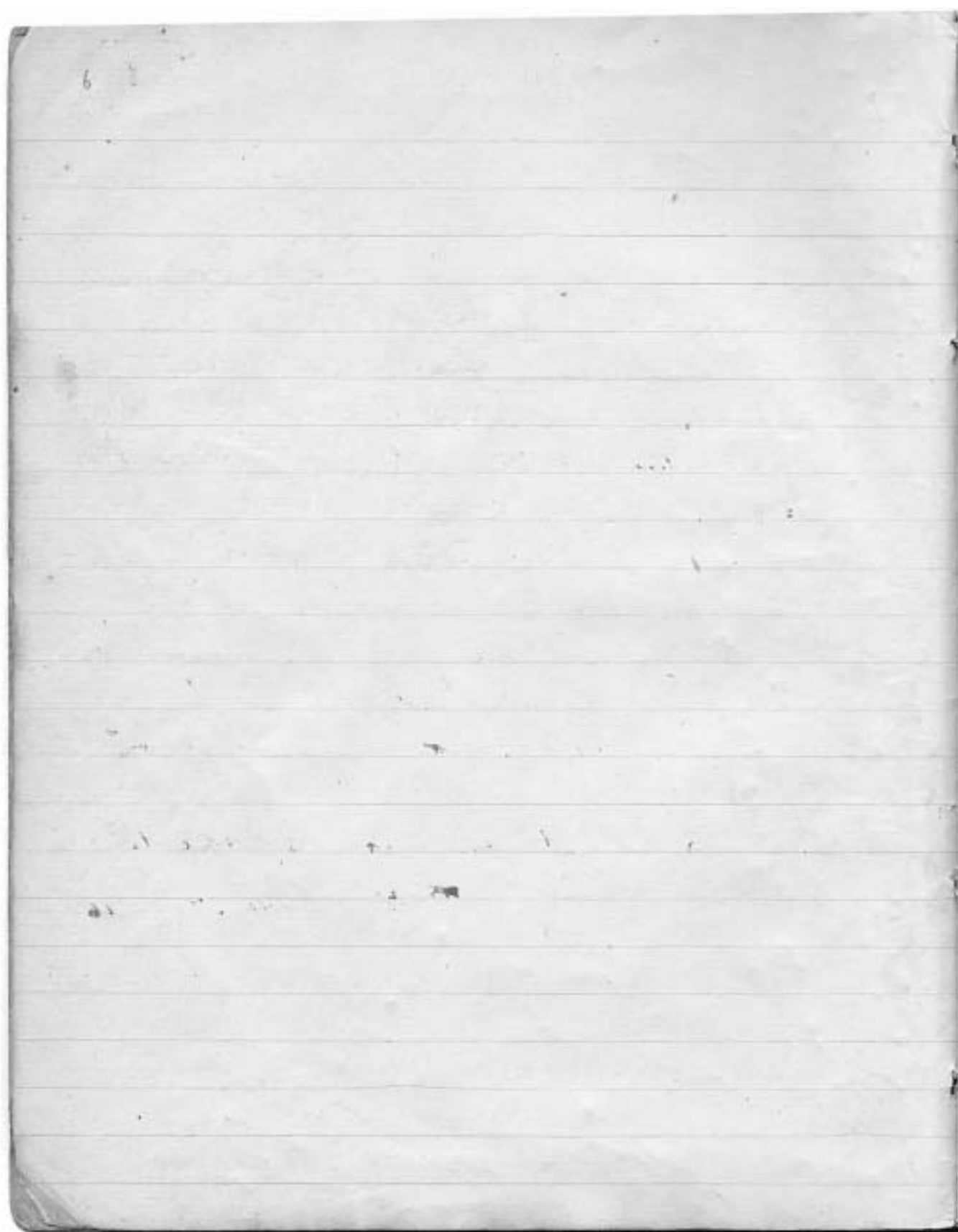

LOG BEGINS

WEEKEND 27/4/46 5- Rendell, Brenda, Iobold,
Nixon, Dixon + Truett —

- 3 down Rod's Pot - many stalactites
found broken - gate required
- 1 - place near Fox's Hole - digging
- 3 small swamp pits to stop water.
- (2 - return to Bristol) SMT

28/4/46.

4- 3 down Reads Key, Michael +
Truett - Main Chamber - Boulder
Chamber - Grotto - Pipe Chamber +
'Z' alley to begin of extension.
Later 6 others in camp - heavy
rain.

Bath Stream partially diverted
to ease flow through. SMT 28/4/46

WEEKEND 4/5/46 Mike out 11:30 Slide by
2 in inside Over to long wood → Fall by gate wet
→ in at 3am by 5:45 back to heat by 7. Nick +
pets coming 2. Continued with work at 'P' 1/2
near Bath. Removed 1 ton after 1 hour close.

After a meal by Nick returned to Rickford &
back by 10.35 - ate & retired to bed.

Sun 10/5 by 10.

Nick & Peter off to CR. Peter
out onto Kaffare by 9 off to BB - careful!!
trip - Nick & Peter later moved the
out of the 'P' hole (near Bob) Mike & Phil
Surveyed 2. Alley Road even.
stick left 4.45.

11/5/46

Party with Williamson left for
Roads 3.00 pm.

Nick & Peter resumed work on "P"
hole. Dig in 4 ft. removed large
boulder revealing many air spaces
behind and strong air blast. Tombo
& Fan arrived 4.30 pm & assisted
in dig which went on into a
boulder. Fill showing great promise.
Dig ended 8.30 pm. Party retired
to Rickford & returned to find

Intel Pond arrived. Ate & retired
to bed.

Sun 19.5.46

Up by 8.30 - Photo arrived 1
- dug at "P" hole for 9.45-6.
2 charges - pushed forward 10 ft - large
rock down.

Bertie, Ted, Brian, RD & Ato over
to Coler Dale Cave - surveyed & returned
after double looking e.p. eva. Ate large stew
& left by 9.15.

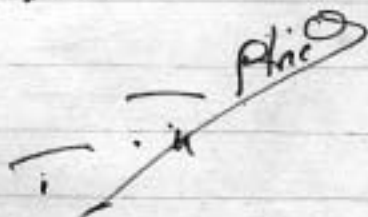

Dale Cave Coler

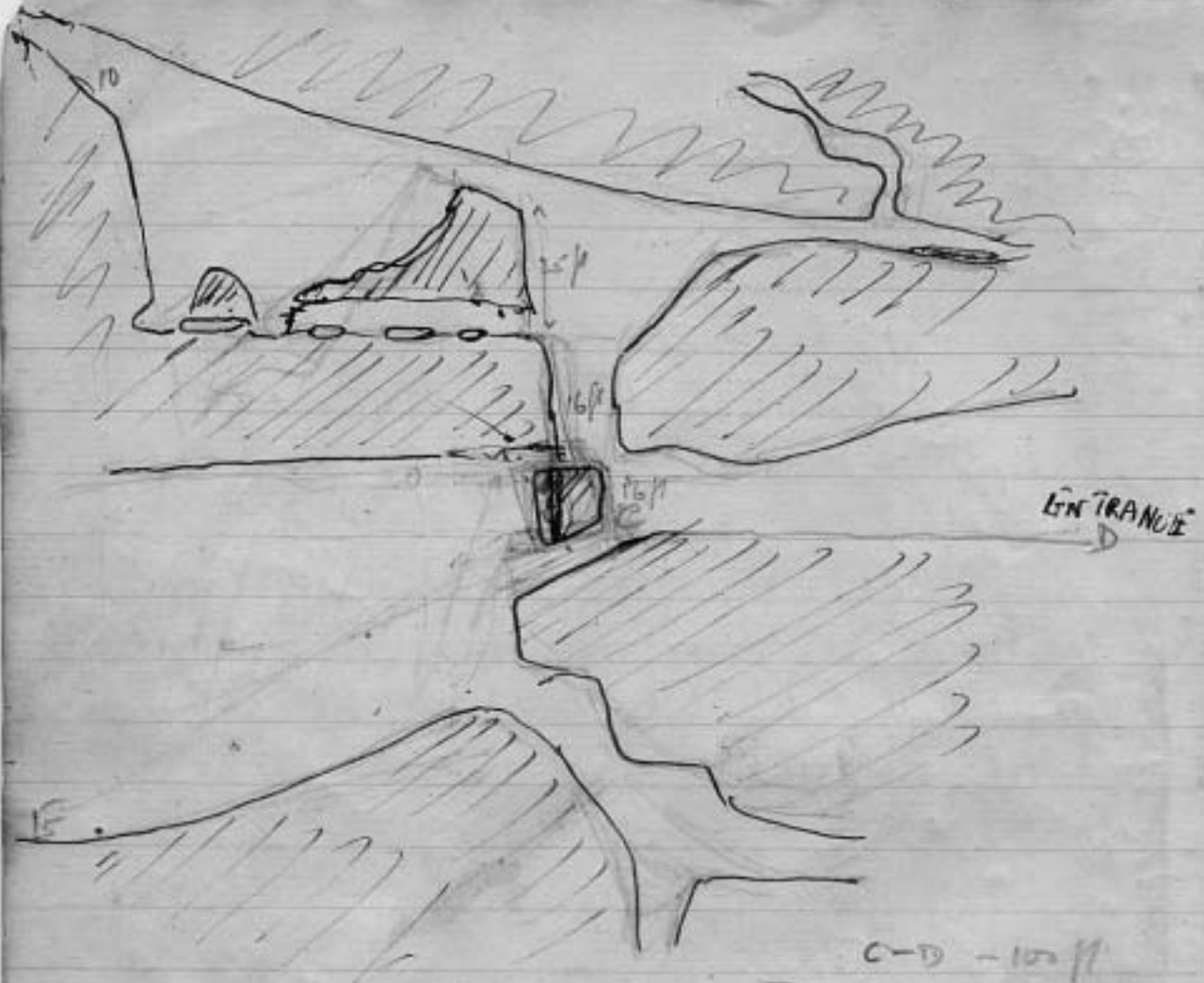

ENTRANCE
D

C-D - 100 ft
C-E - 120 ft

SECTION

OCHRE CAVE

12/8/46

PLAN

11



¹²
WEEKEND
19th + 19th May 1946

Sat 18th

Wakened by 11.30 Followed by Stride
at 2.30. Woke down Ertson Peter + Ian
out + dug forward among stuff out of road at
'P' hole. - Road now much safer. Janis
talked to Bill Deane over for evening - After
steak + plans by the radio. Bill left + all retired
by 11

Sun 19th

Up by 10.30 breakfast by 12.30
(Purridge by Ian - Eggs by Peter) Janis went
off + carried on with water tests. After clearing
in the hut Peter left by 2.30. The
secretary left amidst a series of loud explosions at 5 pm,
followed by rest of party at 6.30 pm.

~~John~~
John

NEEDS 25 26 May 46

Sat 25th

Peter + Nick 1:30 - dug 2 tons of material - removed 1 bundle substituted 2.

Strickland the star, Bill + Photographers + Party of John Ann returned to Ridge and 9 bar by 10:30. 2 odd bodies (B+B) out 11 after catching 90 bar - Brock wearing hats + Prattle. ^{Bob} left a. feel. up. ^{Proctor} by 4 p. 4 ^{Ray} 10:30 - out by 12 + 2 odd bodies Green + Clarke + Towett 2. HP. Went down Rock. Idley + 1) removed down GB.

Note: Explosion in P. hole not heard in Pade.

In afternoon

Nick + Peter move! 1 1/2 tons + 1 blow. Port over to Plantation - Well arrived + dumped equipment. left. Got forward left. roof Pally in. length measured + found to be 57 ft. turning to the right at end.

Center have the lat line

Note suggest survey + sinking shaft

We at 7:30 (Nick & Steve) + John + Ann
 arrived 8:5. (took luggage & nick of Ann's Car)
 Peter + Nick left 8:10.
 Steve left 8:20.
 John left 9:--

Fri. evening, 31/5/46.

Took party of 1 woman & 1 boy down Road's Pot.
 Trouble with lamp which simulated bonfire. Cooked meal
 & left circa 12:30 am. Bernard & Paul

Weekend 1st & 2nd June 1946

Woke out of slide early in morning went off
 to Coral Cove into attention of Perry's - closed
 by concert - so after inspection of area - returned
 to hut Peter Nick & McDermid out
 Pollard by hotel & friend Bill -

2 evening party of hotel Bill In place to GB.
 10 out by 2. Post to Rutherford & Paul

Plan 4 by 11 - Mike & Steve off to ~~the~~ Per. Home

Circle Creek & Alaska - back by Pico-olach.
 Hatch & Harv & Bill left in afternoon.

Bertie turned up & helped operate
 in 'P' Lda (under Peter Pappas) Rod & wife
 with Johnny P. turned up about 6. ~~19~~

LOG HAS NOT BEEN WRITTEN UP
 FOR 3 WEEKS

WEEKENDS: 21st - 23rd

FRI

Woke in camp 10:30. bath entered & the
 ground sediment shovelled out. Cut wood. Redish
 & wax arrived 4. Oil & candle flame / and
 why in the dark some ant people use a lamp
 without getting it clogged with soot?

Missing: Hammer, hatchet, both keys, 1 oil lamp
 and 5 plates.

Washed about and ate. Mally & her Grand arrived
 & left 7. Retired 1 o'clock.

The log of the last 2 weeks is being set on by G. H. H. at his earliest convenience.

Sun 21st
 3 men arrived by 8:00
 left for G.B. 11:00. Back 4:30
 Full trip, rather dark. Encountered
 Barber, Margate + Molly in various stages of
 excitement with large party. Sifted about 4:15
 [one returned to dig in surf]. Kay + J Pitts in cat
 munched Wilkeso Whiteford + Archie Buckle in Rod's.
 Women, Rederth + Mac left G. Rest retired to
 Reelford. Six in surf.

Sun 22nd

Rose about 10. Two Cambridge students went
 down G.B. with Kay. Rest floundered in Tinto
 dig near Foxes. 15 buckets of — removed,
 Sack cards + Paul Duffin in cat. ate and
 all but Kay + Mike left by 9 o'clock.

Sun 24th

Rose about 10. all + left at 1
 but saw nothing.

M. Sumner

Thurs. 4th July

In camp with portions of bicycle about 11 am. Spent 2 hrs working some twigs with wire, ate + left for G. I. In camp. 6. Ate large meal, cleaned hut + out. Left about 10.30 pm

M. Gummer

WEEKEND 6-7 Sat Sun July 1941

H. to out Sat. Plan. Start out in

Apt. Aspected new dig reported by Brenda on Thursday

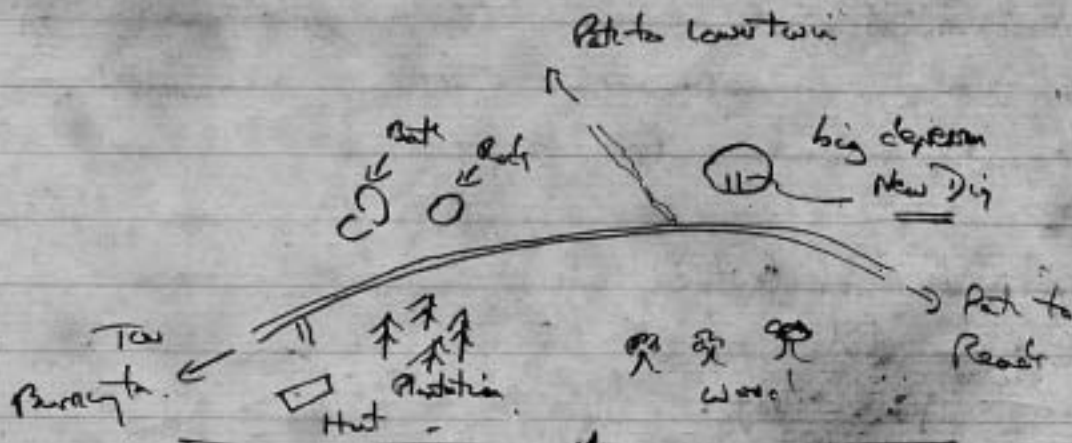

This new dig is about 20 ft deep - 20-30 tons of Rocks have been dug out (its debris + a small piece exposed - some brought down here

Person responsible are unknown.

Dues to Redford about 9 back by 11
back by 1

Fun up by 10 - breakfast by 11 - start to
to try to sell inside between 11 & 1 an

late went over to 'New dig' again.
- Met Robert School cover who appeared to be
responsible - they have been working there for 6
weeks - have never applied for permission -
understood it was common law - will perhaps
apply for permission or fill it in - Note - 15
have now wired in the dig.

late drinks + Bros. Leslie turned up - great
happy evening - early, they left with Mike about
10. Stoke also overnight

Men

Photo + film all prospecting by Peck - small
to Brian Beach - Jags + Beer - Redford
closed until next - thurs
return at 10:30. Be!

Tues 9 by 10:30 - all to Peck will
Cambridge State's from Dept. - Dave Williams
+ out 3-beds - left 5:30.

10
off 10/11

Thursday July 11

Liz & Brenda out. - V. hot
 weather. Therefore only road's grotted. Entrance
 badly blocked. Escorted by Liz resulted in
 entry, but only 1 with very great difficulty
 in. Caught 9.5. from Bournemouth
 B E H

Worcester 19.7.46

Nick Out Friday Night

Pat

Pete, Mike & Barbara out out of Pond
 & Bob followed - Pat down ~~down~~ to
 Tea. Peter & Nick to 'Redfern'
 Rd & Mike - Barbara & Pat to 'Rouberan'
 - a pygalle evening Bed by 10.

Pat

Q₂ by 10 - Breakfast - 'Nick & Pat' by
 at P. 10

Mike, Bob & Phila inspected Plumbers den
 9 inches of concrete with metal reinforcement -
 underneath 2 layers of Corrugated + the space
 the fire contributes fire.

Later Brady arrived + the Phil, Bob.
 + Phil built ~~fast~~ excellent new wooden seat
 outside sluttes.

Al + Nick Pete + Brady left. Bob + Phil
 den longwood. Left camp 10:45: back 3:00 am. ate
 in bed by 4

MON Struck across at the cracks of dawn, ate +
 left. Bob + Mike across 10:15. ate +
 left at 11. Bob to bus, Mike to Rushford - Barrington
Quarry - camp about 12:15. Left but in scouting
 mess about 12:40

WEEKEND 20-7-46

J.P.

SAT
 — Phil out by 10 am - built at ra the
 concrete the sink under top is hot.
Nick + Pete out by 3 pm - cut
 larger bracket of large Beetle - Hilbert code.

in pleasantness was it

To Rutford at 8 - back by 11
-bed.

Pen ~~out~~ up by 10 - Breakfasted & wash
for arrival of 3 brothers Duke. Pete & Mary Polans
Henry Taylor Mitchell Record - Also Betty
& Pat with 3 wives & 2 Men - Betty
& Paty over to building onto Archie - Eat
party & back by 9 after a drink.
Duke & Paty to RR - Early 4 show
trip to RR. Pat by 9 -
Bern & Jim & The Cott. & Phred
in car overnight!

Pen
up by 9:15 & left 11

Shelley
Kathleen

WEEKEND 27.7.46

Pat Nick & Pete out in afternoon Jala
 + Pete out into vegetables by 6.30 - ate
 stew. Pat & Taylor - ate & drove out
 in evening - had good talk & left 8.30.
 We went off to Pickford - back by 11
 bed by 12.

Pat
 up by 11 - Ate v. large breakfast

Menu

fried tomatoes - in quantity
 fried Polonic - in thick & thin pieces
 fried eggs - 2 each
 fried kippers - 2 each.
 Fried Bread - ad - in exel'm
 tea

After easy rest

rest on bits BATT

4 barrowloads of cement consisting of 10
 grades of sand to 5 of cement - 50 breeze
 blocks laid on batt - bringing it up in length by

water 2 feet - Now about 4' 6" at
 deep end - Also laid back $\frac{1}{2}$ of an
 inch into cement to make it waterproof
 - left top gap to prevent any filly to's
 from passing water into bath & ruining our
 hardware - finished - our work by 7.

Suggest

(i) Lay a ledge all round bath
 to make good seat

(ii) Also ensure that water does not
 run down at the back by cementing right on
 to the pipe from the settling pond above.

(iii) Lay a 12ft concrete apron
 in front of bath to prevent water from
 causing a ledge for the bath to sink into

4

Charles Barker out in A.A. - helped
 us by a general conversation - After Peter
 by Peter & left with jobs for 9.5 Bus
 Peter & Nick left on Peter bike at
 8.30. (rode Charles cycle out
 at the cycle ladder - left cycle in the hut
 Stride stayed overnight - why... left...
 Peter the Pie

Tuesday 30th Brenda & I go out. lit fire
with wet wood - very clever. Went
to Coatchurch, well populated, no
corpses, came out. Kate cleaned
hut & left meagre supply of
wood. Selected 2 ~~bags~~ sleeping bags
left hut as found, clean. 9.5 bus.
E.M.

P.S. Salt in lidless jar was mousey.

Friday 3/5/46.

Ray arrives 4.30.

Cook by 5.30. I inspect bath

P. Hole & ~~stone~~ dig by Pickford
School.

Pickford - back by 11.15

& enjoy meat & sausages
& fried bread. bed by 12.30

Please Sign

4/8/46 Up at 9.00 am

Charles Barber, Bertie & Mollie ~~around~~, Bill Langford
Dinner around

Please Sign

set of two charges in Bath's wallet, and removed debris. But now more easy, and large boulder in floor destroyed.

5/8/46 Visited G.B. Went down with 3 spelios from Midlands introduced by Sett. who has a bad knee and could not descend. Down to bottom, took photographs, and back in 2 1/2 hours. The cave is now dry, as there has not been much rain recently. Gas still blasting in Bath Swallet.

please fix

WEEKEND 17.18 August 46

Start out by 5.30

2 of Wesser met & talked to Charles & friend went down c.b. - left about 7.30 - soon after U.E.C.

NOTE

When the Pec arrived that is PROVOKING MESS - EVERYTHING LYING AROUND - VERY BAD Not good enough!

T.C.

NOTE

It is to be hoped that members will
 in future leave the hut in a tidy
 state - It is their responsibility
 & although they ~~are~~ have but few
 clean habits, some stew members may have
 & in consequence the "unclean few"
 must ~~be~~ have some sense of responsibility
 enough.

B2 arrived out by 10 - led by

12

P₁₂ by 10 - no milk or eggs - breakfast!
 put charge in Plunkers & opened in cover

Perfect. Out down 32 ft drop glass of
 50° at bottom big clots of rubble
 Put charge in hole after digging 4 ft.
 No visible effect - concreted on & left.

7 After clearing up as should be
 done by all members.

J. H. H. H.
 J. H. H. H.

Weekend Monday 23. 24. 25. 26 Aug 46

Bob & I arrived out 2.30 - Cat Wood
till tea time collected with & eggs for
collected right fully for tracks by NOTE
Weaver talked till 2 & bed collected
rocks.

Pat by by 12. breakfast by 1 - Went
over to Bath depression & after making
a preliminary investigation, sent a shaft
after careful examination in a minor
depression, between 2 small

PLAN

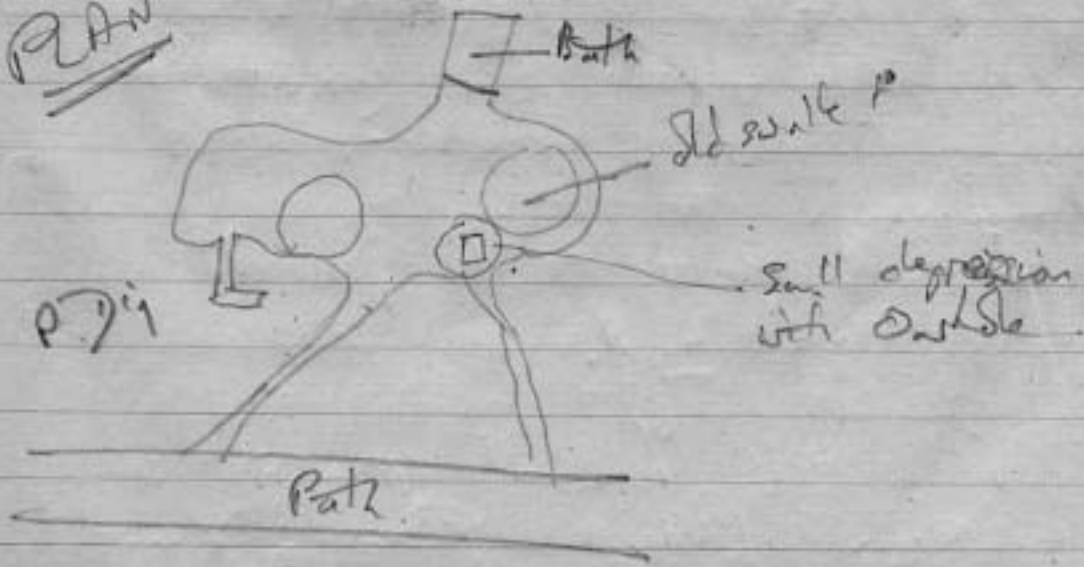

Section

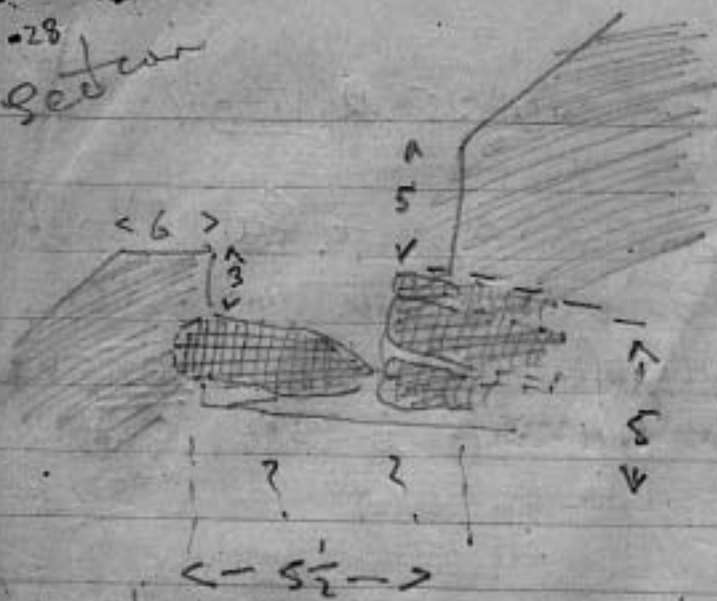

staked off with square hole 5/5

cut for a depth of 5 ft before encountering rock of limestone, restatites filled with black clay the removal of which opened to

impetrable fissures into hopeful draught removed large stone from outside, bed rock & placing our heads in an open fissure to the east side detected a considerable draught. Peter arrived we left

back to hut ate Peter star Norex CC came & ate star consisting of 1 red head - Tudgaw & Paul F. also Charles & company they return.

we took Peter to Ridsford - QP's & back to bed by 11.

Peter Peter rose 9. got breakfast - we ate ham & breakfast retired once more to Bath depresso Peter having left for mine.

Secretary thereupon basied himself upon
search matters concerning the gate i.e. the
lining of the gate - which he completed at
4 hrs strict labour & 2 barrels of
cement - also approx.

Both a complete overhaul into dig.
The W. wall had collapsed overnight
completely filling the hole with loose earth
- cut the wall back after 18" & started
again - dug out floor - removed 6 barrels
& 20 bucketfuls. John Porter arrived
removed 1 large boulder from floor of dig &
continued to dig under slab of rock on E. wall
- draught now good enough to extinguish
cigarette lighter - left for bit - expected
at 11:00 4 course wall & left for Portland
- left John at bottom of hill - back by 11
in by mine left by

After clearing but very hairy W

[Signature] 26. P. 96

WEEKEND Pat. Fr. 31. Aug. 1st. Pat 46

Pat Pat & Nick out in aft - 8/11
to America to water etc. at practice
Habe out in evening - to fire cooked
steak & ate - bed by 11.20.

Pat by 11 - camp + Blang for
breakfast - Pete left for North
Nick & Habe filled in round the bath
& placed blocks - blocks round edge
also cleaned out & filled it.

Pat & Nick arrived & looked
2 Jersey & Pat & Taylor - also
Charles & found canoe & had a look
Charles & Co, Nick Brandy & by left

At 9.5 PM - Mate & Habe in
camp overnight

Man

awoke about 10.30. Both (including
stride!) had bath. Tided out &

test shed and after due deliberation & calculation
 commenced to faint. Area in vicinity of
 sink & fire place liberally sprinkled with
 faint and a fair coverage of cobwebs
 achieved. At about 5, Stride left about
 7, and 4 boys from Selisbury School, arrived
 about 8. Retired [to bed] at about 10.30.

[Signature]

Tues 3rd Aug

Arose at some unearthly hour when
 coherent thought is impossible (about 7.30).
 Breakfasted over a period of time & left for
 left for Spatchwood about 12.15. Descended
 to final chamber & returned to camp about 2.0
 Mike & 2 others ^{from Selisbury Sch} down Rods. A small but
 ventable stream was running in thro' the
 entrance and a considerable amount of
 loose detritus has been washed out. Boulder
 just inside the entrance have shifted and
 several have slipped down into the rain pannes.
 A large boulder had rolled over the top of
 the larger ones to a block of about

NOTE

NOTE

32
NOTE

3 in yds has rotted away from the roof immediately above. Further investigation seems necessary as the whole upper part appears to have been affected by recent heavy rains.

I'm camp by 3:30.

ate about 5. 8 miles left for 9.5

M. Jamieson

Retired to bed at about 10:30 P.M.

Wednesday, August Sept. 4th 1946.

Awoke at 4:30 A.M. and all had woken by 6:30 A.M. The gale which had raged all night ceased and it rained for only about three quarters of the time, permitting the replenishment of the wood bunkers but causing us to decide to return to Salisbury on Thursday instead of Friday. Three of us left at 2:20 P.M. and explored the abandoned water works tunnel mostly ankle deep in water and went into the end chamber of Aveline's Hole. We then collected some fossils and returned to the hut at 5:20 P.M. We retired to bed about 9:30 P.M.

W.M.C.

Thursday, Sept. 5th 1946.

All had arisen by 7:15 A.M. We are cleaning up and hope to leave about 11 A.M.

W.M.C.'s RECORDS OF THE 'ARCHAEO' CLUB OF BISHOP WORTLEWORTH'S

Friday 6th

Nick + Mac in camp overnight

Sat 7th

Rose about 12.0. Mike, Bob, Jack,

Dumbo, Strick and Peter arrived at another
hour. Bob + Jack dug in new Bath dig. The
attention of the rest were directed toward
the composition of one of the most descriptive
mixtures ever to be dignified by the title stew.
Feeling in need of fortification Nick Peters was
retired to Rufford, then sent to Bowberron. Returned
in a pleasant condition about 11:30 with a saturated

Sun 8th

Rose about 8.0. An outport of

Ralph, Bob, Jack + Mike worked in Bath while
Dumbo covered bath apron. Work was considerably
expedited by helpful conversation supplied by
rest of party, Bester, Wolf + Terry.

At bath after several attempts to enter
by new dig, a sword shaft was put down
between new dig + old scallet. about 4'
down large boulders were encountered

a deal of fanning & 3 blows created an
 aperture large enough to enter.

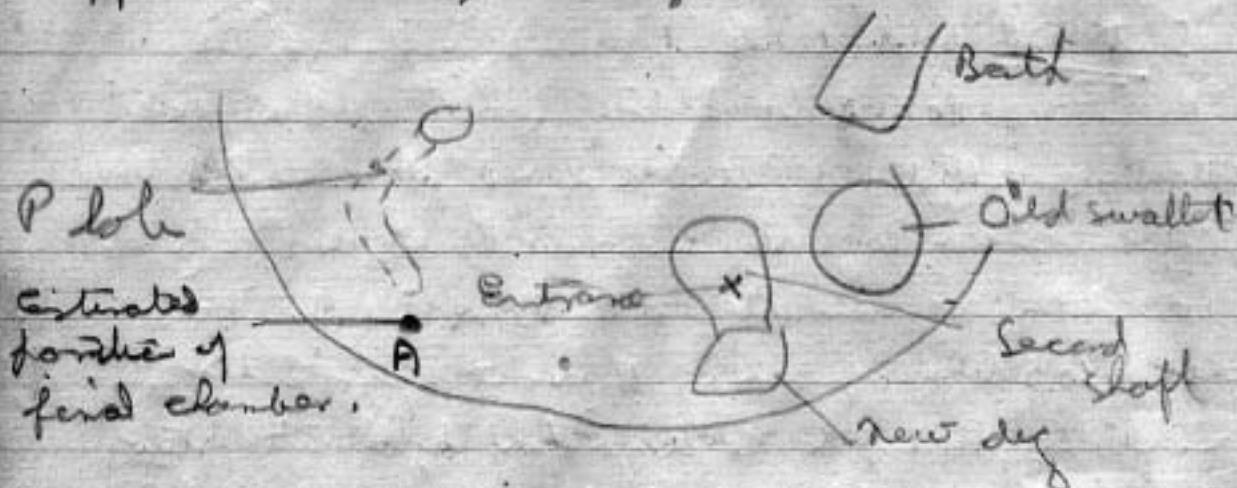

Stones could be heard falling about 20'
 By dropping vertically down a narrow
 rift for about 15' a mass of large
 boulders was struck, a last exploration
 by Bob while revealed that all obvious
 passages were closed although several
 could easily be dug out. All passages
 were not explored as Bob had no solution
 to Bristol & only one last evidence led
 to function; the entrance of further passage
 being prevented by Danbo wedging himself
 in the aperture.

The direction of formation of the cave is:

rather doubtful as yet but a small
 reasonably ^{solid} chamber was entered (containing
 a small ¹ strobiliferous flower) which seemed
 to lie directly under P hole. at least
 talking in latter could easily be heard
 the chamber in the farther part reached.
 Estimate 40' vertically down and 50'
 horizontally to point A.

ate + all but stuck, now Dubois mine
 left before 9.0.

Monday Home about 9.0 ate + left
 at 11.0.

WEEKEND Fri. Sat. Sun. Mon. 13.14.15 & 16^m + Sat 16^m

Friday: hij + Brenda out about 5 - no
 key, so went for walk. Nick + Phil at by
 7. lot in L + B. Quiet evening - pitch
 tent for the birds. Mike at about 9.30

All to bed (got to tent) by 11.

Sat: G by 9 - breakfast - Mike + Phil met
 in job, + wind in the new Bate. Pullet

Nick & Vito put on bell tents. They arrived
 & let a lunch. — all the ^{got} ^{meat}
 for arrival of large party & had coffee
 Welsh party started arriving about 5:30 — All but
 A. Hill here by 8. Stu John Peter & Peter called
 & roasted & baked goats from Hillside. Had
 large meal. Main of Welsh party under
 leadership of Nick & Pete off to Relford &
 Roddy & Curtis arrived. Also Dick Atkins
 Dife & brother Noel. Party of John
 Kay Rod Lee Mike Jack & Matt to Relford
 then + Bears left all in John's car about 11.
 Rod & Curtis left earlier for Relford. Back at 12
 Party of John Bernard, Mike Jack & Bob, then
 Peter Perrett. Nick, Pete & some of the Welsh
 down Relford. Most in bed by 11 (with
 large N^o of tents, but etc present) Some others
 on floor table, clothes shed & everywhere in the
 place.

Party by 6:30 — goats started it. Breakfast
 by 9:30. All except following off to L.D.
 Bob Jack John Witherin & Peter stayed on had
 coffee & continued with Dick in Bull hole & Wade

Pls. Retrieved plots etc to Hibberd, Charles &
 Mac out in aff - went down Bath. Also Bette
 & P.S. Del. pr etc + left by 6. R. Hill. Platte
 + Nick Pete Mike Debo off to Redford. Post were
 out had talk + left for Redford with Bette & P.S.
 viz + Mike else. All back by 10. bed
 by !!

Plan of day 9 left by 11

19th Sept - 23rd

Thurs

Rechie McLaughlin Bill McGarrick 3 etc.
 Drunkards Hole descended but there's no
 future in it.

Mike, Day, Johnny W. arrive Bath. Inspect
 Bath Hole. Mike home in evening.

All 4 to Bristol Sunday evening except
 McLaughlin.

McL. left for 7.35 pm Mon.

Back

P.S. Letter from one of Welsh campers
 asking for his boots left last weekend
 Can find no trace

P.P.S. Hibberd has buried pickaxe & shovel.

58
Wed 27 Sept 46

Plve. 21 by 10.30 - to bed.

Hat not in good form.

Pat

Wife aside only in aft. - Chaley
out + had for success with certa
long 2, oct, evi. Russell Adewid. & after
delivered to P. R. Paul with Paul, Tom &
S. J. of W. & Mac (for layard trip)

Wife 4 - Breakfast - W. & M.
of the Bath etc. John's - 1/2 for 5/10
not steady - no go. Elmer & Bill
off to Longwood - Easy trip - Nola
clad C.B. Also } (as per bed)
Tying, the (p. m. under a Nola) & Longwood etc.
- good chance.

All even + thru + set for evening

Plan

4 by Off by ...
33.22.6

SUN 6th Oct Frisden Wealand.

Strid Danto Kay Bob Borden Burke + Noxell
 out in afternoon. Ralk to party of tracks
 down Gualdard, Burke, Danton Charles
 to Forewood to look at saw dig.
 Bob Jack a mile down G. B with the
 subject of improving the amenities of camp.
 All in camp by 6⁰⁰ ate faramable stew
 & left by 9.

M. James

WEEKEND 20-21st

Mike out at 2.30.

HUT IN DISGUSTING MESS !!!

and several articles left outside.

May one point out that while the hut is provided for members' convenience rather than outside a certain group occasionally require to use it, and it is a hell if such persons clear it after tea. It is wasteful of time & space if the clearing up has to be done as a ritual at hut in order to make it suitable for funer habitation.

- APL took 2 packets & went out
- 1 packet left + Mike in evening
- 2 packets (B&H & M) over to Rowena
- back by 11 - Bed by 1.

Sun

Up by 9.30 - Cleared up hut - cut wood
 + almost filled Buters - collect vegetable
 etc + breakfasted.

Mac + Heeter + Bill + woman out
 in Aft. 3 prelat + 1 girl pull trip S,
 Rock Pt. - Depart + Aft. 9 hours by
 out + also down Rock Pt. Out by 1.30
 (3 1/2 hr trip) - Steer by Mac - Cleared up.
 Mac + prelat left by 9.30 Steer by

Mike

Note

The remarks made by Mike at the
 beginning of the deck log are recorded by
 myself - I regret that any people are
 selfish + disrespectful enough to take advantage
 of the fact that no responsible persons are present
 + leave the inside + outside of the hut
 in a condition unfit for its habitation.

by ever pigs - we were forced to clean out
the inside + outside + wanted a good
deal of time over this.

It is to be regretted that if persons
considering themselves to be members of the Society
act in such a one-sided manner again it will
be only fair to the rest of the Society for me
to tell them to refrain from using the hut in
future. We are quite prepared to do this
& uphold same by the changing of the lock of
the hut + the issuing of new keys to
persons who we know are responsible + decent
cases - only.

Just think on it.

Yours
sincerely

The Secretary

20.10.46.

WEEKEND 26-27-03

John + Jan out - All - 5:15 to
 8:0. Pick up Joe + Stride ^{Hect.} ~~at~~ Jack.

Pat + Nicka party down Tongwood at 12:30 pm
 - out 4:30 back T. Breakfast to
 bed 9-1

Sam Charles near blow by tree trunk - rest
 had easy aft @ Pass off side left 4.
 Johnny Jack 6:0 left 5 - rest later

John

Sat 2nd Nov.

Lewis arrives 10:45. Two saws outside hut - Why?
 Also what has happened to our notes? I have never
 seen the inside of any hut left in such a filthy
 mess by any self-respecting (???) campers anywhere
 before. What about it, Stride? CHUCK THEM OUT!!
 Lewis leaves 11:0 - will probably be back later.

WEEKEND 2nd + 3rd Nov. 46.

M. L. & party arrive 11 pm
and set about tidying hut. Leave for
by B about 2 pm.

4 Predors John Sitter + 3 women
& Whiteford

Bob, Jack, Kate by a flat over to Barbara
- back before 11

Whiteford & 3 women left
Quiet night -

P.m.

== Up by 11 breakfasted. - Elsie &
Desmond out - together with Bob Jack Kate & I, off
to Butswater - also Pettlement who arrived sat
Bertie + Ted, Peter + friend also over to party - all
except got down - nice easy trip to bottom &
back in at 2.30 - out at 6 3 1/2 hr

Party to improved under able leadership of Kay
All back by 7. At 8 pm - Charles & I left
Bertie & co left earlier

Hut cleared up thoroughly (W.D.) & left
by 8.

W.D. [Signature]

9.10

46

WEEKEND 9-10 Nov

John W. Deo Walker

Audrey Blake - Joan down Foreground 1.00

Back 7.30. Mike out 6.30, Des +

Waves left at 10.35. Strid arrived
10.39

SUN

Arrive about 12.0. Brenda Fitz + next
party of 3 down G.B. Rest + John P. + Chaly
over to new dig in Foreground Valley.

Worked about 4 hrs and removed 70-

90 buckets + gold down 5' going early
+ room enough to work. Very promising

all in work, Strid + Chaly left 3.30.

Rest ate + left -

M. Jones

Wed 13.11.1946. Ken, George & party of 4 arrived
circa 12.15. Hut rather untidy. Left Party went
down Sidcot. V. pleasant trip. 2 men discovered
chopping down ash trees about 30yds behind
hut. Said Hiblerd gave them permission.
Left circa 8.15. W. Redish

Sat 16.11.46. Mike, Margaret, Hugo, Bob, Mitchel
Johnny down Rods lot Mike doing stew,
very tasty. Trevor Ford (Sheffield John W.
Lett and friend arrived late. John Johnny
Bob, Trevor Lett and friend stayed the night
talked covers till midnight.

Lun. arose at 10 am. Weather lousy. Frank
Hrost and Tudgey called for G.B. Key to take
party of Scouts down. Bob and Johni followed

Wenda 1; 1) Dethard down long wood lane about
3 Back by 7.20 with

Johnie Maggie Peter + Phida to lay wood Dig
Moved 1/2 ton of rubble - (40 bags) to We agreed
4ft deep - rubble fell in + raised on for 12 or so feet

Section

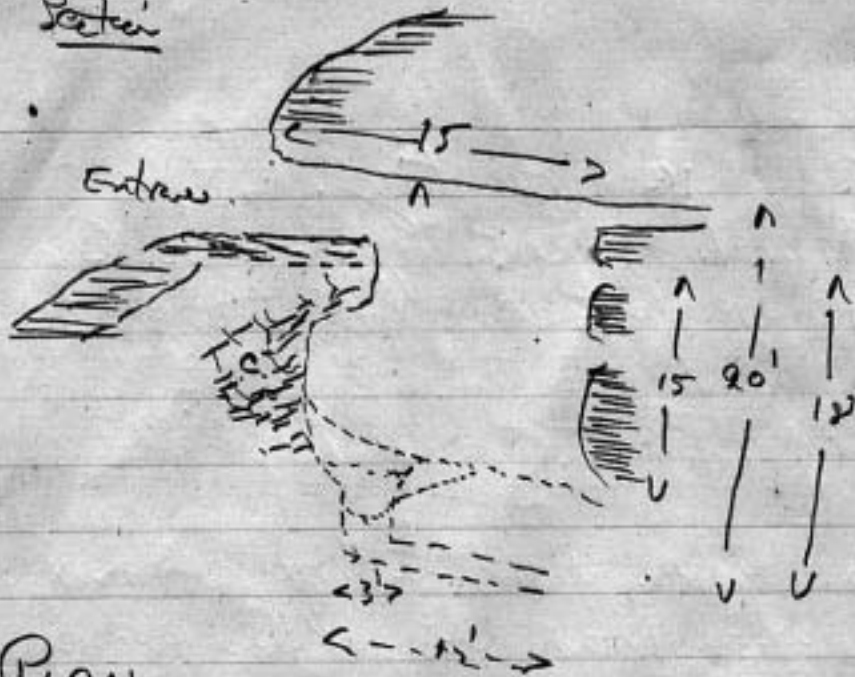

PLAN

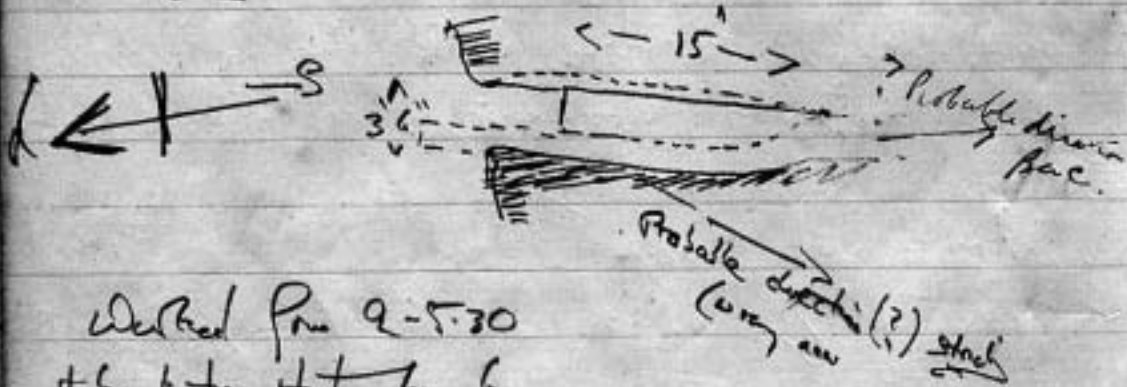

Worked from 9-5-30
 + Sent to Hut by G.

Wed 20th 11.1946

Ken, George + 4 arrived about 12-0.p.m.
 Did Rod's & Road's. Damm Web.
No wood in hole to K.R. Peltis

WEEKEND 21st 22nd Nov. 46

Mike Charles + Patrick out before 12 - over
 to laywood Pitt - Stepped up end + moved
 out buckets of rubble - P.R. Peltis entered
 - continued work - about $\frac{1}{4}$ ton $\rightarrow \frac{3}{4}$ of rubble shifted
 left saw after 5 - back to hole

Levin + P.R. Peltis + P.R. Peltis + Peltis down CR
 got back till 6.45

Also P.R. Peltis + W.R. Need out - other
 (So left) - prepared.

Mike + retreat to P.R. Peltis - mainly P.R. + Deye
 - returned to hole - Nicky + Peltis near. Found 2
 - Peltis + Peltis + Peltis about - Peltis + Peltis
 - back by 1 - all quit 5.30 - Peltis of gentiles
 Vertical under 68-76

check 112-140 (Set)

As regards laywood - we consider that the
we may weeks work yet - tomorrow effort
should should are way or water.

There appears to be a considerable deal of material
that will have to be removed - the best method will be
the use of 2 buckets suspended by a hook to a
rope - if shall the added
if being the st.

It is possible, later, to erect a pulley at the head
of the rift, the this is to be recommended, at the present
time there is considerable danger to the men below in
the possibility of dislodgement of material falling upon him.
- here again - precaution must be taken to insure his
safety - strongly recommend the use of a hat at
all times.

While the ends of the rift must be kept
well stumped to prevent falls of debris - when
we get deeper especially the is most important, as
a fall, might effect the security of a member.

It is feared that we may have to descend into
20 ft before a longitudinal passage may be followed
- as main base lies in the vicinity of a bed plane
at a new point, as was hoped after last week's

effort.

Members must keep a look out for pieces of Archaeological importance - already 2 Pleistocene tools have been found in the dolines - any such finds must be promptly reported to the leader of the Party, who will be held responsible to the society for the security of the preserved site until such a date as he/she hands the preserved area to the Park or the Park.

Members who use the route through Mr Yang's farm at Langwood are requested not to interfere in any way with the farm proceedings - It is preferable that vehicles do not be left at the farm, but rather be driven on the line toward Pung's slight farm & parked at the terminus of the road - & the route across the fields be traversed to the car - members will find this way very much cleaner & easier than the route through the farm yard.

NOTE

The rift is an Antelope P.D. Council land & not on Yang's land & provisions for us are being made of his path, we are under no obligation to the Yang.

NOTE

Members visiting Langwood Pallet are reminded that they must pay 1/- per individual to Mr Yang of Langwood Farm
21.11.61
A. Percher

Punch

Breakfast 11.

John Potts out by 2. girth & collar left.

John, kang John B. & Phil over to long wall.
 - shifted about 20 buckets of cobble, the
 material fell down for about 100 ft - completely
 raining yesterday's work - after some more
 work we left at 6.

If progress is to be continued, the work of
 the water cage ~~to the~~ must be shared on
 otherwise the details will entangle rain work.

Mat & the party left at 8.15 after
 clearing up.

pro
 H. Lewis 29.11.46

Note

e.g. care must be taken with the
 radlock & to be watched for the edge of the

25th Mon.

Arrived 11 a.m. 1 log of wood.

Did Goalchurch. Left 3.30 p.m.

G.A. Hoopfield.

Pat for 31 Nov 1st Dec 46

Pat Angl. Place, ten P. 2 (LTS)
 out in evening - Paul long saw &
 ave out of - MUST NOT occur AGAIN
 Quiet Night

in

Angl & ten down boat

Rue Dura + Abel down Reach 2. 11h
 - also Peter & Pat - treat forget
 tonight still passage at ad - no use
 - elect has big - her left skates & wallet
 - only 6 -

left 4 p.m.

Pat
 G.A. Hoopfield

Dec 1st Wednesday

Arrived 1:30 p.m. solo. Set out for
 G.B. Bike broke down. Came back +
 did Roads. Why? Left 8:0 p.m.

G.A. Hoopell.

P.S. There seems to be no candle
 progredone recte!

Dec 2nd Dec

Wise (B. & L. night in) lunch

4 chemist arrive 12 noon. lunch
 2 proceed to G.A. Hoopell about 3 pm
 Return 6:30 pm after uneventful trip
 4 chemists (Miss Frank Bruce & Joan) leave
 to catch 9:5 bus. Spend night in
 hut alone.

Mon 3rd Dec

Get up 11:30 pm light
 fire & cook breakfast.

Ralph Mink arrives 3:30. drops
 clothes. Tea at Cafe. Mink leaves.
 We leave to catch 8:15 bus.

B.W. Hoopell

Wed. 11th Dec. Redish & party arrived
 circa 3-30 p.m. No Wood in Hut.

Successful trip down Sidest.

I stayed overnight left circa 4-30 p.m.

K. A. Redish

Dec 13th

Bob and John Miles arrived during
 afternoon. Miles returned to Bristol

Stude and Shales arrived at
 9.40 a.m.

Hut painting started

Stude & Donnavon went to tea
 at Mrs Dobson's. Shales went
 to Longwood in his pajamas.

Hugh & Johnny came at 2.30 p.m and
 were followed by Bertie and Molly
 Hut paint continued.

Account 21/2/21 of the 11th

Chas & John both out until 11th
 both spent out in evening - after dinner
 Rowson was visited - for evening of
 Bette & the aff. giving definite promise
 of the presence of the 11th - A
 note of confidence was not passed in the
 absence of the aforesaid party.

Retained by 11 with S. Baker & P. Harvey
 who the 11th after returning latter &
 respects.

Bed by 2 on by 12 - breakfast
 by 2

Recently saw the Hibber also ~~was~~ 15/10
 + says in 7 hrs of great year for
 week. - this is a great pity for the society
 likes people to keep to the word.

Clear on the 11th through in the afternoon
 + got a plan of Progress - replaced 18th
 of the Society since that someone else had
 had ten at Regency & burst to hit - play
 cool in evening & retreat to bed
 early

Monday 23
in early & left by 11.

John H. Peetley
Jan 22 1946

DECEMBER Fri Sat Sun 27, 28, 29 Dec 46.

Fri Charles out 4:30 - fire very abnorr -
Stuck around 6:30 at good meal & retired
to Rickford - returned by 10:20 - C. made
able attempt to teach S to play SB.
Put up by 11. Sen B. arrived - cooked
good breakfast - cleaned up & retired to
logwood on 2 rollers - did a very fine
job of work in removing overhanging portion of
ground at entrance - cut it back for 7 ft
a Recommendation of Dr Baker BSc, ARIC.
after mutual agreement had been reached with
the Honorable Secretary N.B.C. Retired to camp
& ate chicken 1 leg of mutton 1 vegetable Pudding
& White sauce concocted by Dr Baker after a morning
Jaeger & Whitehouse for Mithras - an abnorr. feel

Retired ed?

Sun. Note by 11:30 ~ Breakfast by
12:30. ASD left 3:15. ASD had
spent many laborious hours cutting wood
working in - cleaning (ie removing steel
pegler pit) Erecting chimneys - clean
out grate - sweeping floors - cleaning
out the pegler debris - finishing floor
that ~~wouldn't~~ keep.

Note The above statements are
not bills over - they are a plain
statement of facts.

IN FUTURE PERSONS WHO
PROVE THEMSELVES IN CAPABLE
OF CLEANING UP AFTER THEMSELVES
WILL FIND THEMSELVES UNABLE
TO USE AND THE FACILITIES
PROVIDED BY THE SOCIETY AT ITS
BURLINGTON HEAD HEADQUARTERS.

UNIVERSITATIS BRITANNICAE SIGILLUM SOCIETATIS
HARVILLAE PASTORALIS
— ~~the~~ —
xxix/xii/xlvi

NEW YEARS EVE CELEBRATION + CAMP

Tues 31st Dec → Sun 5th Jan 1967

Chats o first cut by 6:30 - Blawie & Jenera - Proceeded to cut wood & get coal road

8:30 Bertie Blank, Cushing, Smith, Bill Jones arrived. They followed by Roddy at 10:15
 large meal: 1st day - stayed (by Bertie)

Potatoes + several sprouts.

Peas.

Christine Pudding - Plum Pie + Cakes
 + quantities of the stuff of life etc.

After being with new year in the usual fashion (authorized version) the majority of those present had a Pig-Lang around a very sticky pie + then proceeded to eat leave on
 get had.

Wed Chasler. Mike Cushing, Smith + Frank go
 9:10 - After breakfast Cushing + Smith left
 - As three retired to the logwood
 raft by the use of 2 buckets + rope

Spulley etc removed Paul (70 buckets)
 and left by 5.

toe to camp - ate 1 chick etc
 + Charles returned to Bristol.
 Mike & photo had a quiet evening & went to bed
 early.
Thurs 4/14

Mike, Charles and Hon. Sec spent afternoon
 at Longwood digging at dry ditch. Returned
 to camp & joined by Pitt. Bicker for
 supper.

Friday

Arose very late. Hon. Sec returned to
 Bristol in well. Breakfasted. Charles
 & John went to Wincoburn on errand
 for food. Had fried fish tea and spent
 evening at Rickford.

Saturday

High came out just after breakfast
 (2.30 P.M.) and further digging was carried out
 at Longwood. Mike returned to Bristol in
 evening.

Sunday. Arose late. Breakfast. Packed
wood & chanced up. Returned to Buntine
C.B.

Fri 10th Jan

Ken & Day out 3 pm. Large
wood supplies! Some paraffin & candles!
Raining hard so played chess all
evening.

Sat 11th Jan

Day arose 8 am & light fire.
Ken drove by aforesaid fire.
Jackson (PT instructor) arrived 12 pm.
Mac arrived on bike 12:30 pm.
Ken Jackson & Mac down Midcat 2 pm.
Meal at 4 pm

Sun 12th

Dobson arrived 12 noon. Dobson
& Mac proceeded to G.B. 1:15 pm.
Had photo taken in Upper Lyatts
by B.A.C. group who also informed
us of "6" torrent thru Devil's elbow.
Proceeded to Devil's Elbow and found
3" stream. Nobody seemed to know

Turned back.

~~Mon 12th~~

~~Day went into Bristol~~

Robson returned to Bristol with
Peg 8:30 pm.

During Evening somebody called
Bradshaw called to see if
Ralph Morse was here. Said he
was being put up for membership.
Ken & Mac returned 1 am.

Mon 13th

Ken & Mac returned from
chopping wood sawing and clearing
up. Washed all crockery.
Peg returned from Bristol 8 pm.

Tues 14th

then left 9:30 am. Ken & Mac
proceed down Roads 1:30 pm. There
much time trying to find 7 alley.
Explore many passages. Went down

passage from Boulder Chamber.
 Very tight. Much travail. Returned
 to hut 9.30 pm. Day had supper
 ready. Retired 12 ~~to~~ midt.
Wed.

Day arose 7 am! went to
 get milk. Breakfast 11 am.
 Out wood. Dinner 4 pm. Retired
 Her intention to Bristol 9.5 pm
 Bed 12.30 pm
Thurs.

Arose 10 am. Breakfast.
 Cleaned up hut and washed
 up. ~~Retired~~ Day 2 more returned
 to Bristol 2 pm.

Sat. 9. 1933

Hugh arrived 2 pm. Met Prof. Hever - the
 2nd Secretary of Society - Hut in clear condition
 H. B.E.C bastards arrived, also Bertie & Molly.
 Stev. Made. Stride arrived. Party went to
 Rumberow. Molly, Bertie & B.E.C. went afterwards.
 Bed 12.

Hugh went

Sunday Jan 19.

Hugh went to [unclear] Nick, [unclear] & [unclear]
 arrived. — Digging at [unclear], 60 buckets!
 Sledge made on return. — Left 9 o'clock

B.E.H.

~~WEEKEND~~ Sat Pm 25th 26th Jan 1961

Hugh out in Aft. Charles Mike (Pete)
 arrived late later in evening — Seth & (Pete)
 arrived even later for (Pete) — Red by 12
 by 1 — Cut out — cleaned hut — Bell
 & Co left about 3 — He went off to [unclear]
 Mike & Charles went down to Cape —
 [unclear] cleaned up [unclear] erected chimney etc.
 [unclear] [unclear] [unclear] & [unclear] — close to
 laywood — [unclear] & [unclear] arrived — needed
 40 buckets & got down to 3 big rocks
 — require sledge to break [unclear]
 back to hut — cleaned up & left

Red 1/2/61

WEEKEND 8th Feb 47

Woke out in Hobbs at 7.15 -
Bed by 10.30 - up at 8 - Hobbs
required some 5 hour attention - left in
afternoon after being by

2/2/47

WEEKEND 8th Feb 47.

wife out sat about 11am. Walked to Tynny
& 2nd wood & back. Left about 5. Snow ~~fell~~
heavyish. 2-3 in 2 hrs.

Ralph, Jack & Bob arrived 8.10pm. M. from
loafed, ate and eventually slept.
Rose 10ish ate chocolate up and left
about 4 in hopes of getting back

R. Bendall.

Sat 15th Feb 47.

Went to home on the morning - 7:20 PM
 later - side table & chair in box - bed
 by 1-

Pen by 9:20 - 7:20 PM
 PM on the bus by 1:30 - work till 5:30
 - broken by 2 stars 40 buckets - sink
 later in the day read - Also Pine
 & Nick -

at 7 - at 8:30

Spent time clearing up
 weekend's mess & cutting
 wood left 4:30 pm

W.M.W. Anglin

WEEKEND 1 + 2 Mend.Sat.

MacDougal Loma + 2 God. out at 3 mile
 → Kefworth out at 4. Mac walked to Cleddes
 Beach at 8. Ate frugal meal + Lona
 → 2 beds left for 9:0 from Bas. Returns
 about 1:0.

Sund.

Arrive latest site: David arrived
 about 1:0. Kef + Mike left for Kefworth
 Berte + Rite arrived at site. Remained
 about 30 Bushels lowered floor 3'.
 Going not so easy. Back about 7:0.
 Des + Mac down Rods Photography.
 Site + left about 9:0.

M. June

WEDNESDAY 8th Nov. 67

8th Nov.

Myrtleby Hallamson arrived 3 PM
 commenced lumbering. Bob & Jack arrived
 5 PM. continued log cutting. Strove 8 PM.

Remainder of night spent stoking
 fire, intending setting, & listening to
 Strove. later theory on the topic of Strove
 & the night.

Elkham

9

9th 10. Myrtle Jack. Post

got breakfast ready & cut wood.

Breakfast finished 10.20 The Jack (P)

Office desk done E. Twiss & K

trunk of & for the & had to get the Post

the - owing to excess of ice & was up to
 - but to put.

In afternoon Mr. Dyer, Dyer
 & the Myrtle & the not out for a walk (a flound)

levels:

— Road (P) at 547

Roads 510

At 528

Mr. Bendall + Cork out also

Hugh + John left: 5:00.

Major Hoki + Hoki left: 5:30

Bernard + ~~Ray~~ left: 5:30

Jack P.S. Mr. Bendall ^{and} + Hoki left 6

off clear ↙

Andy

WEEKEND 15 15

Mad Aughi + Lena + John + Bob all out
at 10. Don G. B. Rattford
mile out at 8:0. Geoff Mac + Jim in
cap over night.

Sund case around 11, all Log
entered 12 in. Dummick + set of B.G.S
down Road. Mac Geoff + Lena + Della
Bodie Kate roll, Brenda Nick + Kate Hys
out at vesper time. Both classes out,
ate cleared up + left about 7:46

J. J. J.

WEEKEND 22 23 March 47

Sat / Chas Bob took out last Apr - (P27)
 of Explorer's Down CR (led by Ralph Marshall)
 - got in for a Devil chas - left in evening.
 3 rd to 2nd Rowdown - (Paul Miller Baker
 set then - certain amount of difficulties with Mattie
 Back to L1: L2 - take + Bob started rock of
 Apr. - led by 9.30

Sun up by 12 2 corners high side.
 at 9.30? - wet down (read) 1 Ally - back
 by 2 + left in Apr. Chas Bob + Inke left late.

Demand out by 1 with Patrick
 chas Picket - note - stone in lower tier has been
 drilled to enter the E part of Picket series.

With Picket one descent right down the line
 - passes squeeze without noticing proximity of
 adjacent walls - physical sense interesting features
 of the lower series + spent but 1/2 hour climbing
 2 things 2 lower series Down 2-6 pm.

Had 2 BEE tiles - 33 pectinade - didn't like
 an anyone - back to hut - ate - closed h +
 left by 8. Picket the lowest 23.3.47

Sat 29th March

Lorna Mae arrived early. Miss
Miles Dental Charles Cooper (~~Anglo Tex Oil~~)
and another ^(Anglo Tex) ~~had~~ at in afternoon.

Goathead. Helped free a B.E.C
type truck.

All Charles Dental miles & other load
back on 9.5. Rinkford. Bed 12.30

Sunday 30th

Rose 9.30. Lorna arrived 9.15.

Lorna home to Wells & Warkley.

Mike out ²pm. Cooper went about 2pm
Bed for Wells 8. Gibsons gone.

Mon 31st

Jeff & Margate arrived 10.30.

Lorna home. & Jeff down Kidest.

Jeff & Marge left on 9.5.

Tues 1st

~~Very busy morning~~ Very busy morning,
over blankets and spring cleaned.

Jun 2 Dave (Lynn's brother) arrive
with car 3 pm. Cut ~~the~~ much wood.
Retired early.

Wed 2nd

Rose 10 ish ^{all down} G B 9:30.
very wet. In back 6:30 am. Gick
arrived 9:30. Retired 12.

Thurs. 3rd

breakfast 9. Gick to Bristol
9:30. bleed up cut wood etc.
Lynn's car Dave Max left in
car 12 pm.

BW M. Laughlin.

EASTER CAMP April 3-8 1947

Wed 5:45 Gick arrived.

Thurs Gick went into Bristol + collected a couple
glades of the lake - plus tables for road +

Dennis.

Presently John P.H. Cheryl Barker of back
arrived

Red by 1

Frid

up by 11

Get wood

Reconnaissance of Survey by Erik + Dennis

Rained all day

Ratfoot warm

Pat

Cut enough wood for 2 days

Called ^{+ punches} other for 2 days - got organized

BB + Phil return to by feed

Pat

up by 11 - phoned to check away from
various "center" in order to make the "rise"

Treasurer arrived at 2:30 (very late)

immediately A HIVE OF ACTIVITY - 3 PRTux

immediately went off - 1 went off survey - 2 went

down "Crestwater" (PRT + Phil) + took down 10 Charles

youth pole - at two o'clock - in house - down

300' way - got wet - kept collecting that 9:00

- 3rd party went to RHINO RIFT. They removed

50 buckets of material - completely removed the forward edge

Charles need in a large passage 3' high - 2 wide

gas is 10ft get to up-south Pitore in stratigical hole

- height shell is 15 ft - wide enough to turn round

- feeding place to right



Horizontal Section

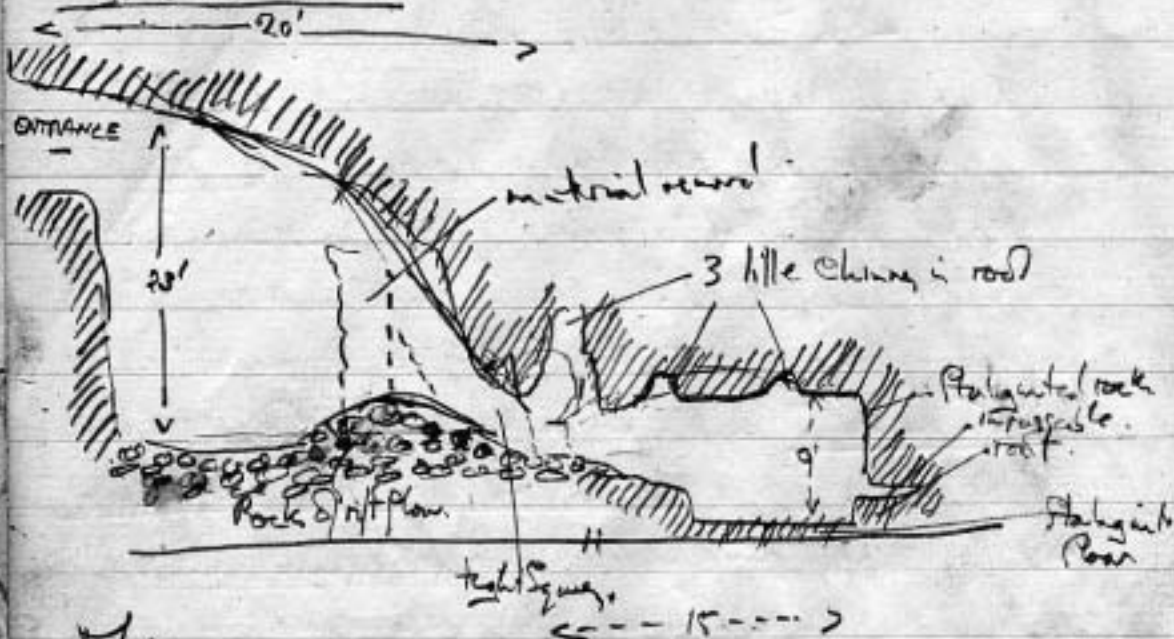

Plan up by 11 - breakered well

Beriet + malle covered by 1 - Chale + John of /
 - like to lay road ATTEND RIFT - Beriet + malle
 pool + slide over in Cr.

John Wilson, D. Whiteford + Macdonald out - latter
 I went down ch.

After work till 3:30 John Pitt found his way
 through island by Charles, Finch, + Beriet + malle after following
 along over 15 ft the rift was found to be impossible
 it may be considered to be a very pretty grotto
 further work if any to be in the stalagmital mass of
 boulders in the floor. - suggests blaster

Also visited Mine shaft $\frac{1}{2}$ way down long wall to
delect bath

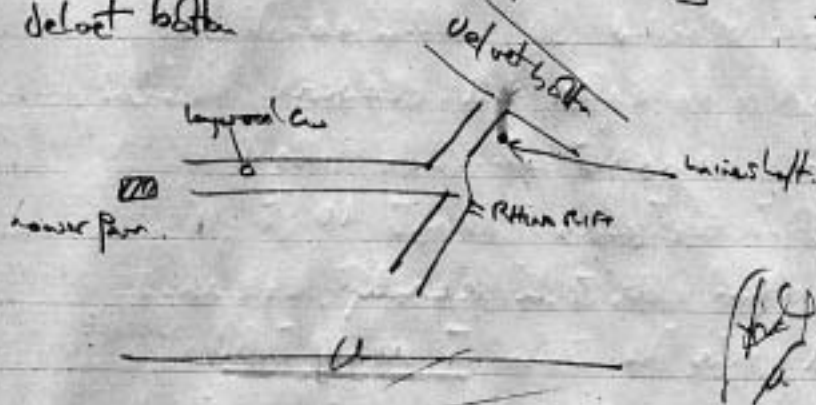

Only 15' clay
+ heavily bedded.
clocked - traffic
probably to be 60'

Tues up by 10:45 Breakfast cooked in trays.
Charles & J. Pitts went off to Blanche for tea & bread
& later went off on top of Mine to prospect one step.
Des & Mac left. J. Coulman helped Pick Contractors. Pick
cut 12 posts for surrounding land lease & later arranged 50ft
on inside of timbered door.

MEMBERS ARE REQUESTED TO MAKE CERTAIN THAT
THE TOOL SHED DOOR IS ALWAYS PROPERLY BOLTED
BEFORE LEAVING CAMP. - It is to be regretted that
the tool shed has to be entered by the hatchway - but it
ensures proper bolting of the door.

Picks left about 5.

Picks

TUESDAY (Cont.) EB & S. Pats visited:-

Cow Hole. Entrance blocked by fallen earth.

West Pit. Appears to be collapsed cavern, similar to but smaller than Sandpit Hole. A small shelf inside the pit extends about 10 ft; 5 ft of this being fairly open. As it is early, accessible, well sheltered and gives the impression it might be worth an archaeological dig.

Devil Punch Bowl Standing water in this and no sign of Platters Boulders (See recent edition of Brit. Cave)

Red Quat Quite a big drainage but shocking place to dig!

Hillgate Swallet. Most impressive! Could not locate precise site of Wells old dig.

Swallet draining under road from marshy ground by St. Cuthbert's had works. Definitely goes into culvert under road. — ~~Swallet~~. A second one nearby goes into foundations of an old building & then under road.

WEDNESDAY.

Crack left in morning. T. Williams, S. Pitt & CB went to longwood Swallow & removed debris from market cave. Then to Rhine Pit & made cavity for demolition of chalk boulder. Second haul in Rhine Pit — a little less despairing. T.P. & CB continued to sandpit hole — saw a pig root to flush the old air there. All went to Rickford in evening.

THURSDAY.

Spent day tidying up in & around hut. Some of the rubbish that idle 'B's' are today to put into pit were removed to proper place. Drain outside hut cleaned out — very strong smell of ammonia etc.!

Please Sign

Sunday April 13th

Ken Reclish & Mac arrived 12 pm.
 Left for Z alley 1:15 pm. Found
 some rare pearls(?). Arrived back
 5 to find Charles Barker expending
 surplus energy building an outside
 fire place. Had meal. Ken & Charles
 left 7 pm on bike. Mac lit fire
 saved wood etc & spend night
 in hut alone. Bed 12:30, up 8 am.
 breakfast. Off to catch 10:10 bus.

BW Mc Sneylin.

Sat April 19th.

Mike, Charles & Ken went out. Charles
& Ken to Hayward dig to blue boulders
& then down to B.

Sunday 20th

Johnny Williamson brought Charles & Mac
out in afternoon. All back to Bristol
except Mac in evening. Mac spent
night in tent.

Please Sign

BV W Langley

THURS 24th April

Mike arrived about 10. ate a considerable quantity of food + went to bed

FRI

Rose rather late. (2 o'clock!) ate; cut wood + eventually trottered to the village for veg. Return to col about 5 + consumed a delicate meal of chips, fritters + eggs. Retired to Blagda where a pleasant evening was spent.

WEEKEND 26 + 27th April 1947

Please Sign _____

Sat Mike Already out Charles + J Pitt arrived — after eating walked over to Rhin Riff + placed suitable equipment about a certain rock. During the failure in action of equipment the effort proved fruitless. Lewis + a friend arrived in the evening. Also made a quiet evening + bed by 2.

Sun Up by 11:30 — cooked + ate breakfast — prepared post for land ker. J. W. Harrison arrived out on MS. Kate left later in aft. Retain + H. M. arrived fairly late + returned with Mike + H. M. to land ker

They erected 11 posts around entire shift -
 worked in the shift - built up the field wall
 - then in with crowd the old shift - talked
 concerning certain geol-hydrological phenomena &
 after windy lull they returned to hut.
 5 pits & Chika went over to Longwood to see
 effect at Rhine Rift - no go - went over
 to Peadar's grotto - viewed poritoidi - returned
 to hut - all ate sausage - eggs & spaghetti
 - dead on - Mike left. rest went on
 to their work - far do - returned to hut
 - Ad left except Ralph - in camp by self army 11
 - by 830 in morning & left by 855

P. 28.4.47.
 H.

WEEKEND

3 & 4th May 1947

Sat

— Charles Hep & Mike 2.30 Patrick proceeds
to cut down very big tree a number of logs have
since been produced - not shown set rabbit snares.
went to bed 12.

Sun

Charles on 10.30 & left for + worked out etc
hit occupants. saw Patrick a Police Constable ~~at~~ -
~~at~~ - gain to right side of house - ate a breakfast
about 2.00 left for Road gate after visiting the car at
Paddy - 2 hrs later returned - entered a small car park
abandon - returned to hut - 5.15 at - at 2.30.

Des Hep & Paula down ER out
Pep & Ralph at in bus - see to hut by 2.10
Bertie took Mike at - Pip cleared hut - very
well too - talk scullered - photo & maps found ditto etc
Bertie & Rosie left 6.30 J. William left 5.45

Pete & Mike left Mike at 8.45
Des left with Mrs. Joyce Keane, Pep & Ralph at 8.45

Patrick
4.5.47

WEEKEND 10+11 May 47

Sat Leave at 3 - Ralph at 6:30.
- bed by 1:30

Sun Treat arrived 10 - g by 10:30
breakfast 11:30 - Treat + Ralph headed
back in morning in part of bats - Charles Nick Brown + Ralph
out off in Treat Car + Pete + Mike to lay wood
- inspected Rhine Pitt + the to haul beer quarry
- back to hut - ate meal - cleared up efficiently
+ left by 8pm.

at 11:30
Aris
11.5.47.

WEEKEND 17+18 May 47

Sat Treat out 12. + the Jatts + Char
out for 1-2 - proceeded to dig a 6' deep
hole - treat repaired water catchment - Ralph out
about 6. Ate - All except Treat went to
Rutford - back by 11

Sun On by 10 - 'Charles's Method' - Breakfast
- the erected Privy sled - cut trees - poured water into
exhaust into box hole - no known results

Ruff took Pth of Hankton Creek last down Postholes
Bertie Haygate & Peter out

Ate Claved egg. Pitts + Chas left 6.10

Post left by T.

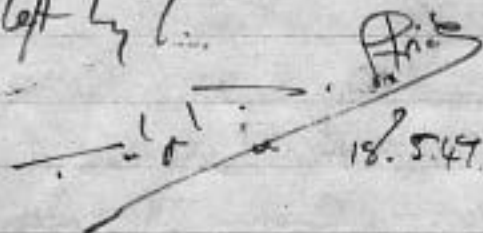

WEEKEND 24 25 1947.

Traffic out freely Nght also back.

Ruff, Pth, Chas out on Sat Morn Hgr out last

Hgr took Chas last down EB.

Tomb Ruff Ruff + Rod of Eibs started

digging at last low sea

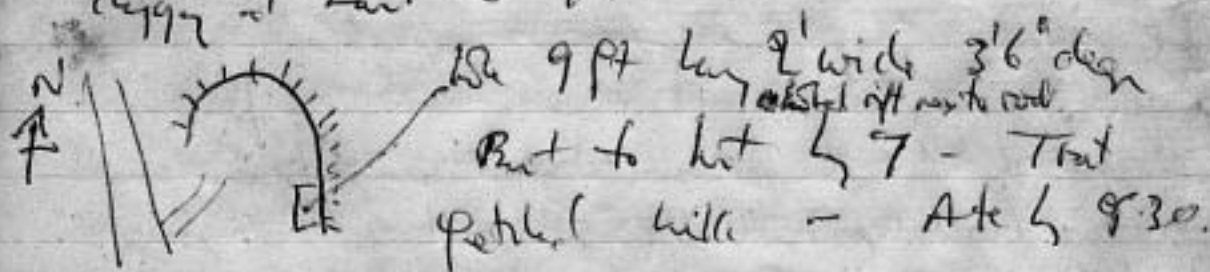

Then Pitts + Ruff made Will

Owing to a very severe exert occurred.

Pitts + Ruff next day

Sun Same party over to lake level again
 - continued trench 10 ft to the North
 2 ft wide & 3 ft high. - Lined several
 large boulders bank by 5:30.

Rod Eide J. P. Kelly & Ann out - seen
 in Richford - bed by 11:30.

Mon up by 10:30 - breakfast Dina and
 Char Pitt & Phil inspect Swallet near Parker.
 Bertie & Thelie out - Went off with Tooth & Clark
 to L.L. Erik continued survey. Phil left
 in aft ~~pt~~ 2.5.47. Charles left in evening.

Tues. Trat left in morning. Pitt removed small
 quantity of earth from the swallet observed the previous
 day and uncovered a small opening beneath the rock face.
 Erik continued his survey.

Wed. Erik & Pitt walked into Klaydon for food.
 Returned to find Charles & Johnny. Wellman
 in camp. Pitts and Charles removed further quantity
 of earth from the swallet. Strachan & Trat were the
 first having been taken Kibbin - present. Strachan
 left almost immediately but Trat stayed until 9 o'clock
 & Erik (usual) continued survey.

Thursday Pitts left the cat in 2:40 hrs, but missed it and also the 4:00. Left eventually at 5:30.

Crick continued surveying.

Friday Crick continued surveying.

Saturday Crick continued surveying (rain stopped work).

Myke, J. Mark & odd bed out at 12:0. Two down G. R. & Myke do later. Exploded under hole and surfaced about 3:0. The terraces which lead from 1st Granite & is supposed to join up with tributary 3 (Received no val 5) had a few amount of steady water about 18" indicating a fairly contact shale.

In camp about 3:45. Hugh & Tom arrived: - well small boy in tow, apparently a part of a dozen or so in bed out and unable to get out thro' one of the jamming logs in a crack. a few inches of rock were chipped off, and the individual extracted, after Crick had delivered a lecture to the party & returned to hut & ate: all but Crick left for 9:30

m/f

Sunday June 1st Donovan, Redish + Brothers +
two Goddesses turned up at noon. Redish etc went
down Grantchurch, Donovan's book completed Sunday
and made preliminary geological reconnaissance.
Supplied preliminary spot height to the entrance of
Rods pit and also to Trig Point above Bos hole (Bident).
These heights cannot be relied on. Their accuracy
probably ± 5 feet. The area surveyed is from
Bos Hole to the edge of West Turn, the Colne
and from the speltic hut to the burnt water.
~~except~~ except for the preliminary heights above, ~~the~~
no levelling has been ~~done~~ executed at all.

Tues 3.6.47.

J.H. Arkman

Redish + Benz ~~at~~ out at 3 did section the
2 penetrat (legul) dip. bed 2.

Wed 4.6.47

Rama out - pit down Road. Rama to
Y 4/2 for Night Hoagell & all night

Thurs 5.6.47. the back to town

Frid 6.2.47

Mac out - trip down Road

Tray 7647

Photographed down Ready
 down to YHA for Night.

Sgt 8.647 - rest Mike and them.

Potts & John out aft - - Pitt Test
 + Mike out to land near 3000 ft
 that work then Jan to Pottel in Ben
 when still in court found of line.

Sgt K. A. Redish.

Potts Redish + RA left for CB at 10-00
 rest Potts & John Potts CB & Sgt
 are to Bowell Caves

Plan of BOWELL CAVES



By means of
 with down

is by 2-outlet

Base line, Pottel C.

down + N. boundary (Potts) 6/11 est fur

etc

left 8.30 to Langford
 3/6/47

Weekend

Thurs 12 — Mon 16th

Thurs 9. Men out to out to log bed by 11.30

Fri 9.20 for breakfast. don
eat & bed 12.30

Sat 9.5 for — wet day
did geotech & Ewing

Pitts steel — Tent Mike Kay & Hy out

Sun up by 8.30 — all down to

Pratt — did sort of — on the back
by 6.30 — up — Tent Pitt & Mike left

Work in Ashubs Hand

Examined outside of ? mine shaft at approx
462556. This is a vertical shaft which looks as
water worn. It lies to the left of the Tynnings/
Bladder Lane. 350 paces south of tunnel.
descent with wood rope, approx 40 ft visible. It's
cut 10 Bench marks for leveling

Monday. Cut remaining B.M.s. (6), all prepared for
 Boring August camp. Located old B.M. in men dip lodge
 lane. Cut on wooden gate post.

Broke camp at 4 P.M.

J.H. Calkin ✓

Weekend Sat - Mon. June 21 - 23 ~ 1947.

Sat 7.5 To Rhino Rift, Longwood. Charge
 laid against boulder. Charge failed to
 explode with detonator

Later 2 move in camp.

Sun. Party to Lamb Leer quarry .. 5.

Started trench against face where
 rock exposed & working S. southerly
 direction towards other trench. Dug about
 4 x 2 x 2 feet.

Later joined by party of 4 from
 U.B.S.S. and party of visitors. Down
 Lamb Leer Cavern & returned . 3 hrs.

Thence to Rhino-Rift where charge
 successfully exploded.

Mon - 4. Visited Rhino-Rift.

Boulder found shattered by explosion
 Reasonable prospects of progress. J.H. Calkin

Weekend. Fri - Mon. 27 - 30 June 1947

Fri EMT in camp. Late afternoon.

Preliminary work on repairs to Bath.
visited Stephens + Rowberry.

Return to camp found D^r + Mrs Crook
waiting. Later they left. Charles Barker
Sat arrived 11.0 pm.

Sat 3 - Barker - Pitts + Tratman to
Rhino rift - joined by Bertie
Crook + Hollie Well. Charge fired
successfully in cave. Repaired "inlet"
to Bath.

Sun Pitts + Tratman - Rhino rift.
Boulder found broken. Two moved
out of position + work started on deepening
of floor.

Survey shows only way of making
progress to deepen floor. Two boulders
in way require change to break
them up.

Mon Closed up camp. EMT

Sun Looked at side of dig close to
Reed's cave. In S. face of excavation
a thick occupation level. Much charcoal

and an occasional scrap of burnt bone.
No dateable object found. Have any
such been found? ~~EM~~

Mon. For notices of members.

The water from washing up etc
that runs off end of table has caused
a patch of "dry rot" in corner of hut.
~~EM~~

July 2nd 1947. C. B. Barker.
Four charges placed + fired
in Rhino Rift. Long Wood.
C. B.

July 3rd 1947. aft.
3 in camp. Repairs to bath
continued ~~EM~~

July 4th 1947. Evening.
3 at Lamb Beer Quarry
continued trench 4'.
Later visited Nannett Throubwell
Breach Hill - no camp found
on Knewle Hill of Chew

Magna on top an earthen
circle with outer ditch.

circle has slight bank + ditch with
diam about 70-80 ft? + comparable
to Kings Weston Down circle.

MS

July 5 1947 Sat

Morning Repairs to bath +
cutting stream channel. one.

Evening Afternoon - 3 -

Lamb Leer Quarry site. Mr. F. Frod
of Wessex Club turned up. He
remembers open rift & states that
the open part was near starting
point of our trench where there is
stalagmite. continued digging there
& found rift wider at one point.

MS

July 6 - 1947. - 1 - + 1 later.

Continued cutting stream channel
for bath (M.G. F.E.H.T.)

Party of 10 led by McOmie down

G.B. leaving camp 12. noon.

Returned 7.0. left 8.0. closed up &
left at 8.30

MMH

Geophysical Logger Keith Tester Camp

Sat 12 July ->

Sun:

Party of Trout, Pick, Pettie, TLO + BEE under guidance of Don Coe down Ash line + Ash line extension.

All things Pump - All out down Coe - Saw 5 very beautiful elements - N4 had a type of Andromeda at foot end with 2 jaws [flaming] + Ox + Red Deer + possible sheep besides many fragments - 5 hour trip - vigorous traffic - 30) BEE got lost on way out + required Rescue party to pick up all right - party nearly out - ate BBS + returned to nearby in a way back - home by 11

- had supper prepared by a Cook Reg - returned to bed by 1 [ladies in tents]

Atts of things to Rline Rift - removed several pieces of rock fragments - progress made require photo work - also noted tent.

Thu:

Up by [lady by] 10 Glennie + Reg to Bartol back by 11 with food - Rest over to Tynnyr by 12.15 - did first traverse of Camp in field near Tynnyr (to S) Picked up 3 - back to Camp by 4

- Reg prepared dinner - eaten + cleaned up by 7.15

Plugs Berye down Roads. Pettie Pulpl into Bartol Bk + Bartol also Reg - the Charles got a sunny - Tynnyr also went out with

sun. bed by 1:30.

Tues: left + ate by 11 + over to Tynings
and 3 traverses near Tynings - considerable
interest.



bed by 1:30 aft
good meal.

traverse left evening also planned
Do return later.

Wed: wet morning - Pitts & Co Sprink + Ryl +
Tynings - Sprink + Pitts local E.C. - the joined 800 are
at Rhin Rift. Rock removed for part of boulder (see x)

E.] - see 10.

PLAN

Rest 4 1/2
hrs do 3 Pitts
traverses in same

area - paving a bedding plane on path to be present
at good drive + bed by

Thurs: Ryl + Ead + home by 9. Rest continued
traverse at Tynings - good evening meal - party to Minors
over into Baltic - considered certain statement in the paper.

Fri This day work continued the weather being fine - 4
traverses were made round Green Highway proving as before

passage to be present.

Sat Back this day to Tynning Pass & Pished travers - proving better place to dig to S from the new hole new better crack.

Su This day over to Tynning Park Pitt L.S. - put 5 travers road & proved best passage to exist to S. needs further investigation - over to

Hies in camp - good evening

Mon Kay & Alice down to chert & back - visit road hut - traffic painted part of hut - over to Bath Arms at Chert & Evening to look party.

Tues 4 caly 11. P.S. by lead of P. looking down Gantford & Reach - Right left in morning traffic returned from home. This day was spent clearing up - 4 days time of food were left the larder.

Prize
22. 7. 1941

WEEKEND

26 + 27 July 47

at

Treat + party of ~~John~~ (Pete) + wife da (ca) + Sophie + Arthur board trip - Devil's Elbow day - relocked core in exit + back to hut - Peter + Willie are also there over to Hines - good evening - back to bed by 2.

in

Party of Treat the offset to Tynny's day is part of rock face

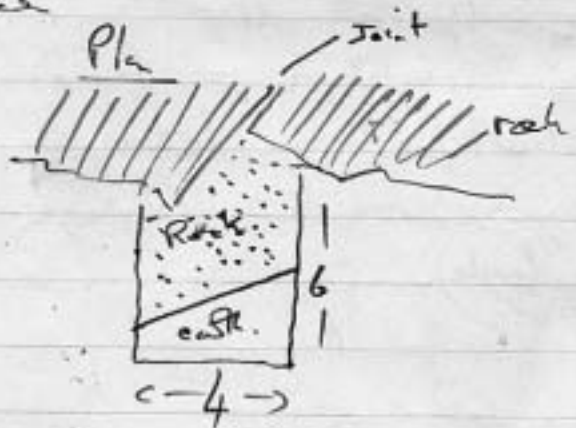
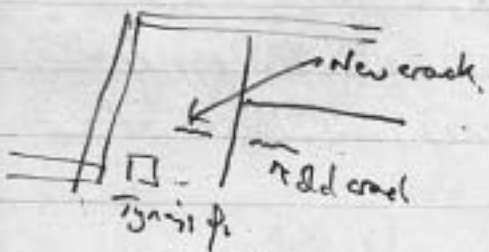

Pectan

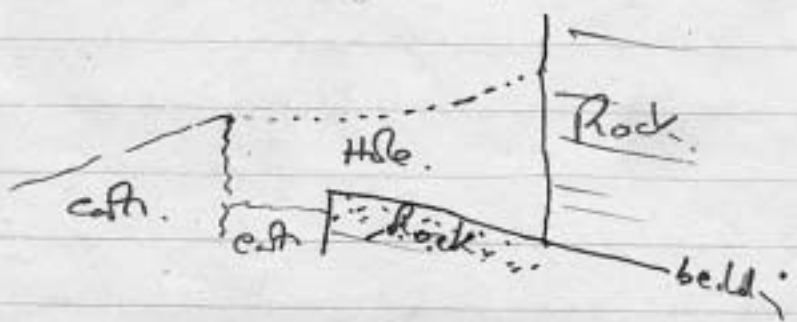

Hot rock floor in hole $\frac{2}{3}$ - in part $\frac{1}{3}$ of
 deeper cut in all same $6 \times 2 \times 4$ cu (ft) material
 removed = $\approx \frac{2}{3}$ ton. V. LT day - no

gen rift of special dimension network - returned
 to hot

very much } The Pull gravel possible for dig
 out - } C. Hoagell - P. Whistl Guy Hearing
 done } Quiet night } After eat, ptd) @ Hot

Mon 28th

Up by 10 - breakfast

G. P. H + L down esp. nice trip ~~Phil + Ather down~~
 continued - later ate + party spent
 quiet evening

Tues 29 Up by 10 Breakfast

Party of George Guy + Hearing down Roads

Phil + Ather down Road - ate at 3. Party

the clearest up + left

29.7.47

SUMMER CAMP

August '47

1st Aug Frid. Eve

Charles out 3 rabbits bed.

2nd Aug Sat

Charles on breakfasted Ralph
 arrived 1 Pitt at 9:30 Creek at 5.
 CCB Fred & NDJ to Rhine Pitt. Had a skill full
 blow. Retired by 8 & Bettie & Bertie out every
 at Rhine Am - bed by 9.

3rd Aug Sun

Up & breakfasted by 11 Rod out by 12.

leads divided people called - Creek & Ralph
 Surveyed (looked) for New Machine house to hunt.
 CCB & JKP to Rhine Pitt. Removed debris
 of blow from boulder - ~~some~~ progress considered
 impracticable. Eve to Pickford by 9.

4th Aug Mon

Up & breakfasted by 11 Rod left

for Har. Bettie & Bertie out. Bertie JKP Creek & Bert
 Surveyed (looked) for hut to New Witham & back
 to New Rock.

Evening over at this inn & bed by 1:30

5th Aug Tues

Up by 11.30. breakfast Crits & Pugh
levelled in from Buntia Creek to the left
Charles & Pugh, also dander & ground used
- ate - Charles got 1 bunny - Pugh Pith & Pugh
to lay food - pair no bear - back to bed by 1.30

6th Aug Wed

Crits in & into Buntia
Charles Pugh Pugh ate & over to Estrato down
380 - Pugh traverse - inspected rift Charles
& John's Route out by Baya - 2 hrs in cave
- back to hut - Crits returned - ate - drink
at Buntia & bed by 1p

7th Aug Thurs

Breakfast 11 Surveyed in from Buntia
to BHE above W. twin. - Pugh on to Wassen
H2, in evening. Past with Pith & Pugh bed by 2

8th Aug Fri

Pugh & Buntia after early breakfast (at 11)
1st survey with Crits from Pugh's ledge over to
then behind Pugh (PSP)

9th Aug Sat

Charles Pith & Pugh - Complete do of
Chickadee cave 2nd & 3rd. - that put into Crits to
Bayer H2. Pugh's cave in Buntia bed by 12

10th Aug Sun: Truck left in Afternoon after Paul's part of surveying work. Charles John & Ryl over to plantation & top of Rockham Hill - inspected various swallets with some interesting features. Landed in evening.

11th Aug Mon:

Truck Charles John, Hester & Hector down C.B. inspected passage that lead up from gorge almost to 1st grade & another passage near bottom - well worth digging. Truck left for home in evening.

12th Aug Tues:

Charles John & Ryl. Helped Dever by making Pan 2-9 pm - bed early.

13th Aug Wed:

Up early - Charles left on 7:30. John Hester & Ryl over to TG mine - last & Trattie had been made to do geological traverse due to breakdown in the apparatus - over to Lamb's last Quarry & Dist pit which were particularly inspected. In evening Hester & Trattie helped the Dever. John & Ryl to Bourgeois.

14th Aug Thurs:

Fitts left in morning, Tattie, Hector, & Pats
over to tuning - continued good work near
Betty's Creek

Plan

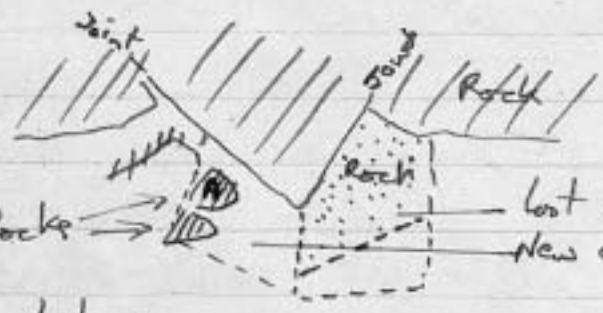

bedding plane
floor is dipping
steeply with great
possibility of opening below.

Removed about 13 cu ft material today - 1 large boulder.
(A) needs removal & Evening Hector + Tattie helped

Wearer has been making
Tattie left in Evening.

Dug the Property. 14/8/49

15th Aug Fri:

Up by 11 - etc - Peter Hunter injured
about the top - Peter Hunter is over - very hot.

Tattie arrived out in eve.

16th Aug Sat:

Up by 11 over to tuning with Tattie
- Dashed from 12 - 4
Pats arrived & assisted
see design over page

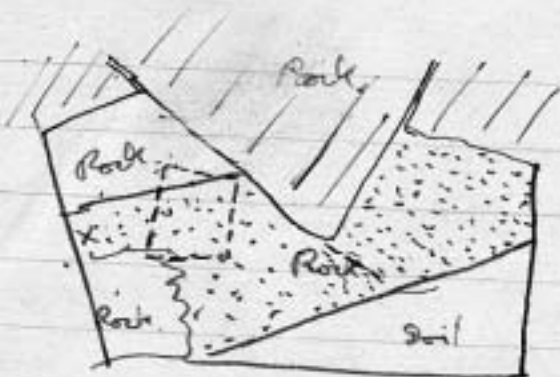

Removed boulder
(indicated by dotted line)
underneath was soft
small rocks + soil
removed about 1 ton
of material

no very open joint in vicinity of guyot + entire
trench at X + if no go try going deeper in
place marked soil + get if possible it more open joint.

2 Eve - traffic behind Dean + gate +
Ryl + Barber - traffic over later + home by 11.

⁴
17 Aug Sun

$\frac{1}{2}$ } 11 - at - + over to look
at Traffic De - the course - the collected.
Barber from O.E.C. top. Back to hut -
Charles arrived - Charles + Ryl left 5.30. Traffic
Mike helped wear.

18 Aug Mon

Tat + alk left by

Ryl + Barber

THIS IS

THE

LAST

PAGE

